

Mount Barker | 8 bedrooms | 3 bathrooms | 6 car spacesProperty for sale in Mount Barker - **\$2,250,000****A TIMELESS EUROPEAN-INSPIRED MASTERPIECE IN THE HEART OF THE ADELAIDE HILLS**

Commanding an elevated position in the prestigious Martindale Estate, this magnificent three-level residence delivers unparalleled street appeal with its classic European-inspired stone facade, grand proportions, and sweeping panoramic views across the rolling Adelaide Hills to Mount Lofty Ranges. Crafted for extended family living, this exceptional home combines timeless elegance, generous scale, and modern comforts on approximately 4,265m² of beautifully landscaped acreage – the ultimate Hills lifestyle retreat.

Step inside to discover light-filled spaces with generous 2.7m high ceilings and solid American Oak timber flooring flowing seamlessly through multiple living zones. Boasting 8 bedrooms (with flexible options for additional uses), plus ample versatile areas across three levels, there's plenty of room for everyone – further enhanced by the dedicated granny flat within the shed, perfect for teenagers, guests, or a home office.

Enjoy outdoor entertaining with an undercover alfresco area, ideal for family BBQs, outdoor pizzas, or relaxed gatherings with friends. The front balcony offers the ultimate sunset sanctuary – sip a glass of red while soaking in breathtaking views over the valley as the sun dips behind the Hills.

Practical luxury abounds: double glazing, large rainwater tank plumbed to the home, terraced landscaped gardens with flat lawn areas, and an impressive vehicle setup including a massive lined garage/shed (15m x 9m x 3.6m) plus undercover parking for 6–9 cars (utilising the breezeway on the lower ground level).

Just minutes from Mount Barker's vibrant selection of shops, new indoor aquatic centre, hospital, top schools, and nearby cellar doors – this is convenience wrapped in prestige.

Key Features:

- Classic European-inspired stone facade with outstanding street appeal
- 8 bedrooms + multiple living zones across three generous levels
- Solid American Oak timber flooring
- Large gourmet kitchen
- Wood heater and gas log heater + heating and cooling options
- Expansive undercover alfresco entertaining area
- Front balcony capturing panoramic sunset views to Mount Lofty
- Granny flat within shed for extra accommodation/office
- Double glazed windows
- Large rainwater plumbed to home
- Terraced landscaped gardens + flat lawn areas
- Large lined shed
- Approx. 4,265m² acreage in sought-after Martindale Estate

This is more than a home – it's a legacy property blending sophistication, space, and serenity in one of Mount Barker's most desirable locations. An unmissable opportunity for discerning buyers seeking space, luxury and lifestyle.

We currently have a large range of homes in Unley and Mitcham Council areas. To inspect a listed property, call Walter & Irvine on (08) 8272 9277, or email us via sales@walterirvine.com.au.

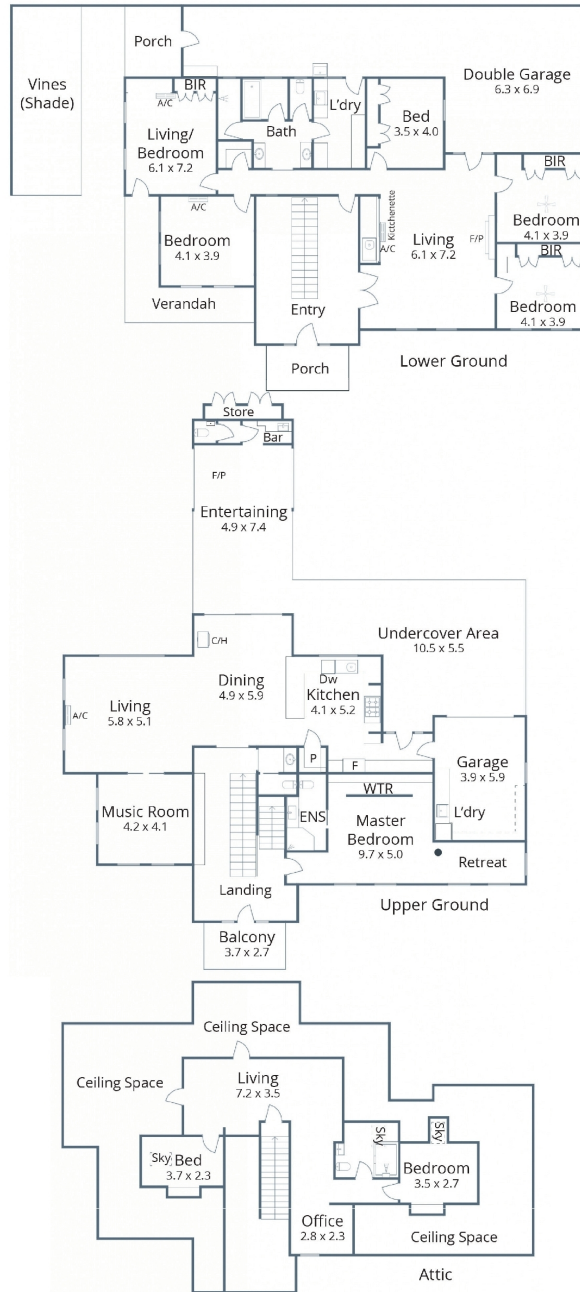

Scale in metres. This drawing is for illustration purposes only. All measurements are approximate and details intended to be relied upon should be independently verified.

DISCLAIMER: The Vendor and the Agents expressly disclaim any liability arising from any inaccuracies of any content in this brochure. The accuracy of the information cannot be guaranteed and prospective purchasers should make their own enquiries and form their own judgement as to these matters. Property floor plans are for illustration purposes only and measurements are only approximations. Neither the agent nor the vendor accepts any responsibility for omission or errors.